



Reliable
SOLUTIONS
ONE STOP SOLUTIONS FOR ALL TECHNOLOGY NEEDS



SolidCAM
The Leaders in Integrated CAM



The unique, revolutionary Milling technology
iMachining
patent by SolidCAM
70%
TIME SAVINGS
... AND MORE!

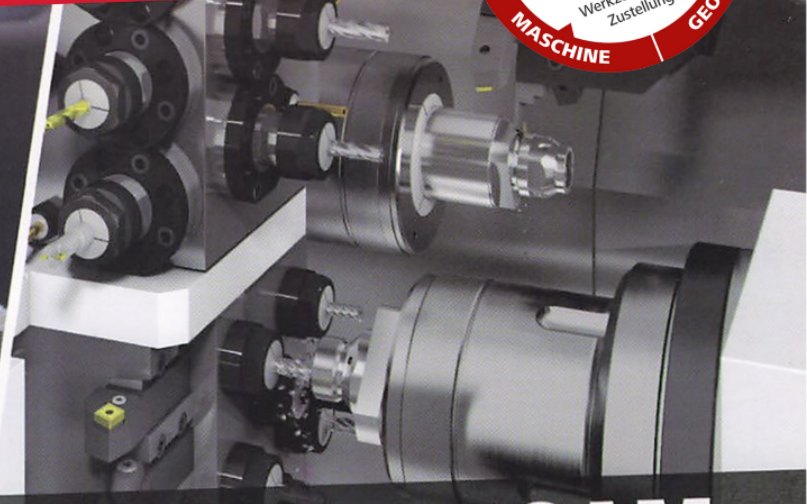

SolidCAM
ADVANCED MILL-TURN & SWISS-TYPE

SolidCAM, including the revolutionary iMachining, is seamlessly integrated in SOLIDWORKS, with full toolpath associativity to the SOLIDWORKS model. With the single window integration in SOLIDWORKS, all machining operations can be defined, calculated and verified without leaving the parametric SOLIDWORKS assembly environment.

All 2D and 3D geometries used for machining are fully associative to the SOLIDWORKS design model. If you make any changes to your SOLIDWORKS model, all of your CAM operations will be automatically updated.

Major Benefits of Using SolidCAM in SOLIDWORKS:

- **SOLIDWORKS Look & Feel** through seamless single-window integration
- **Full Associativity:** Toolpaths auto-update when model changes
- **SolidCAM's 10+ years as SOLIDWORKS Gold Partner**
- **Works in the SOLIDWORKS assembly mode** to define Fixtures, Tooling & Vices
- **SolidCAM + SOLIDWORKS is scalable** with packages for all CNC machine types and applications

SolidCAM

the iMachining Edge

SolidCAM is the Complete, 'Best-in-Class' CAM Suite for Profitable CNC-Programming in SOLIDWORKS, supporting all CNC-Technologies:

- iMachining 2D
- iMachining 3D
- 2.5D Milling
- 3D High Speed Machining
- High Speed Surface Machining
- Multi-Sided Indexial Milling
- Simultaneous 5-Axis Milling
- Turning & Advanced Mill-Turn
- Wire EDM
- Solid Probe



+91-9579508147; +91-8010572083



marketing@reliable-solutions.in

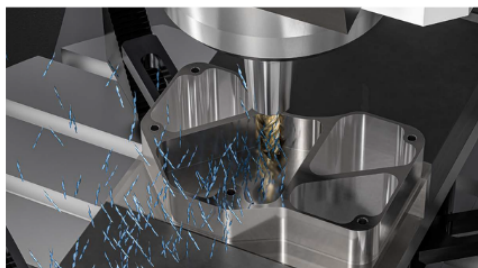

iMachining 2D

- Dramatically reduces your CNC machining time- Time savings of 70% and more!
- Unmatched increase in Tool life.
- iMachining's Patented Technology Wizard provides optimal Feeds & Speeds, taking into account the toolpath, stock and tool material as well as machine specifications



High-Speed Surface Machining

- Distinctive CAM module that takes your 2.5D machining far beyond profiles, pockets and faces
- Enhance your 3D machining capability by driving along specific surfaces on prismatic and 3D parts
- Total tool control to attack specific areas without the need for constraint boundaries of construction geometries



Simultaneous 5-Axis Machining

- The most tested and proven 5-axis toolpaths in the industry with the most advanced control over all aspects of toolpath and collision checking
- Pre-programmed, 5-axis strategies get you up and cutting instantly
- Instant feedback with real time, life-like simulations complete with Cutter & Tool holder gouge checking



iMachining 3D

- Optimized machining of each Z-Step, using proven iMachining 2D technology
- Deep roughing utilizes entire length of the flute, shortening cycle time and increasing tool life
- Intelligent localized machining and optimal ordering eliminates almost all long positioning moves and retracts, producing the shortest times in the industry specifications



High-Speed Machining (HSM)

- 3D machining taken to an entirely new level of smoothness, efficiency and smart machining
- Speeds up slower machine tools and unleashes the speed of faster machines by eliminating inefficient, unnecessary moves and air cutting
- The fastest and easiest way to generate the most advanced and best quality 3D toolpaths

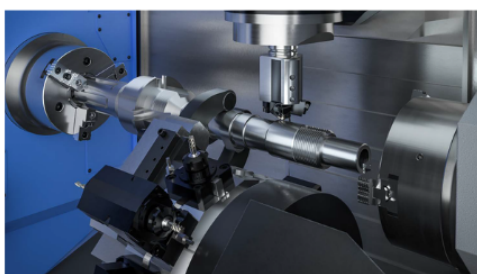

Turning & Advanced Mill-Turn

- Supports all the latest multi-function CNC machines for combined Milling and Turning
- Complete multi-turret and multi-spindle programming with full simulation, seamlessly integrated into one extremely powerful package
- Intelligent management of rest material between Milling & Turning operations limits air cuts for the most efficient toolpaths and reduced cycle times

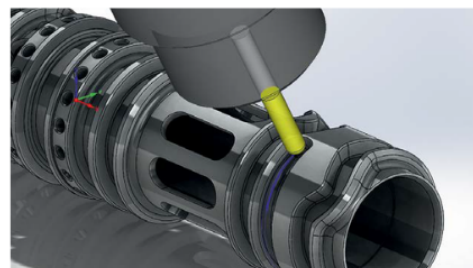

2.5D Milling

- Straightforward, SOLIDWORKS-style interface, combined with the latest technology for the fastest, most powerful and easiest to create 2.5D toolpaths
- Designed for the advanced user and the novice. Full "Pilot Controls" provide unmatched power, "Auto-Pilot" feature recognition automates programming and gets you off the ground quickly

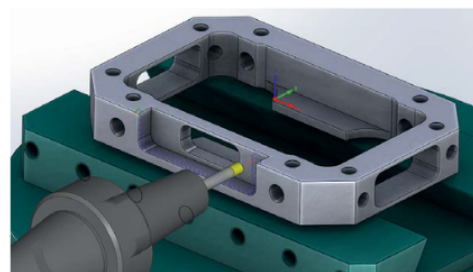

Indexed Multi-Sided Machining

- Experience single machine home position with One-click orientations for indexed setups
- Speed up multi-sided machining by eliminating multiple coordinate system constructions
- Eliminate manual G-code editing or setting up multiple work offsets at the machine



Service and Support

- The most experienced, knowledgeable support team in the business with extensive machining experience
- Dedicated Post processor team ensures compatibility with your Machine Tools
- Powerful SolidCAM Professor video tutorials cover all features and uses of SolidCAM available 24/7 at www.solidcam.com



Our Website



+91-9579508147; +91-8010572083



marketing@reliable-solutions.in